

At the Micronics Engineered Filtration Group, we take pride in our legacy of strong, trusted filtration brands providing Pressure Filtration, Vacuum Filtration, and Air Pollution Control/Baghouse Solutions.

We are problem solvers. We provide personal attention to address each company’s filtration challenges, goals and objectives. We are committed to building strong, long-term partnerships with our customers and earning their trust each and every day.

Whether with filter media, advanced filtration equipment, maintenance and service, or spare parts, our team of filtration experts is committed to our customers’ success.



PARTNERS IN:

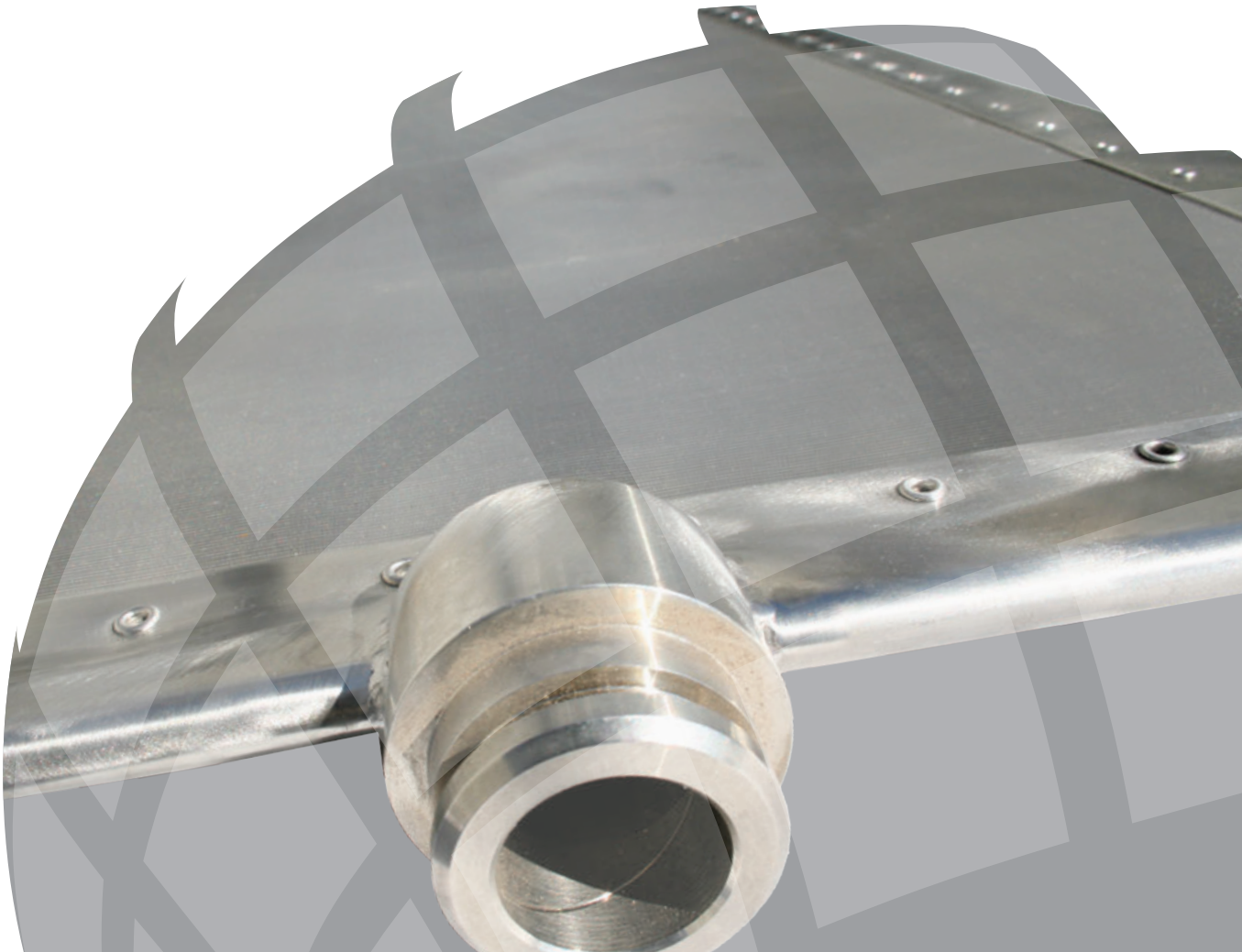
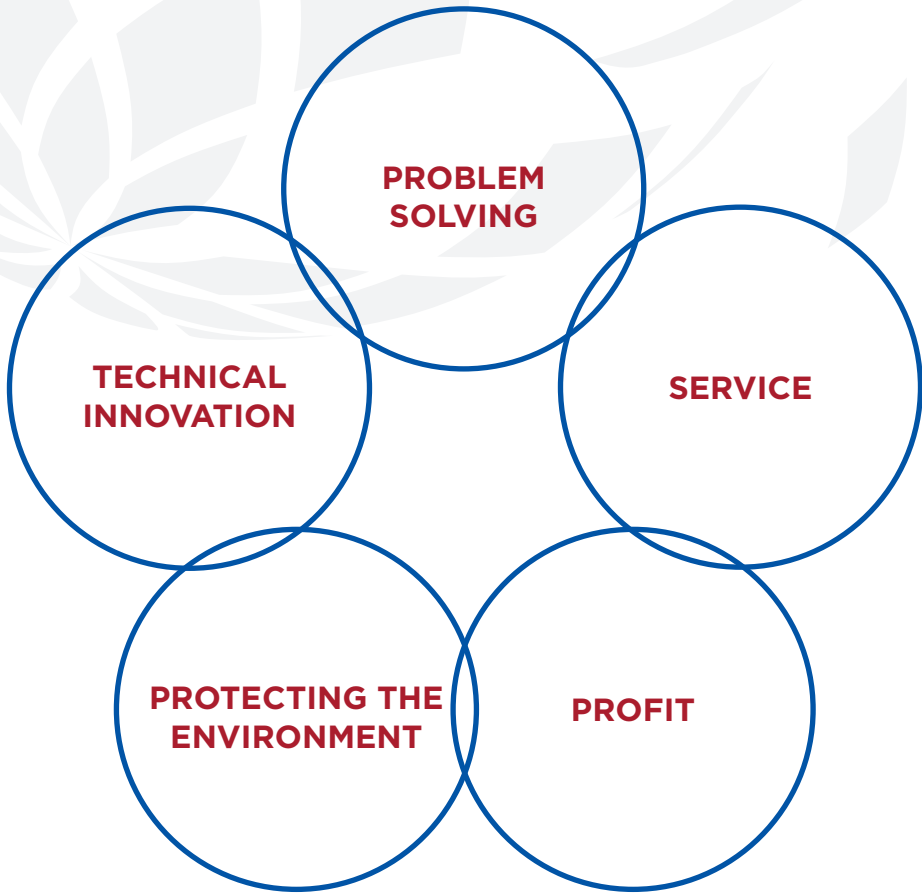

PRESSURE FILTER LEAFS



LEAF CONSTRUCTION

Select from the most popular binders and chambers. The leaf closure can be welded, bolted, riveted or a combination of the above. Leafs are available in 304,316 and 316L stainless steel or other specialty metals:

- All sizes and shapes
- Most binders and chambers available
- Welded, bolted or riveted construction
- SS 304, 316, 316L or specialty metals of your choice
- Leafs engineered for balance and tension
- Exceptional dimensional stability
- Long filter frame life
- Use with synthetic or stainless steel covers
- New Filter Leafs
- Increased Production
- Leaf Rebuilding & Repair
- Leaf Rescreening
- Shaker Screen
- Pressure Vessel Screens
- Synthetic Leaf Covers

RESCREEN

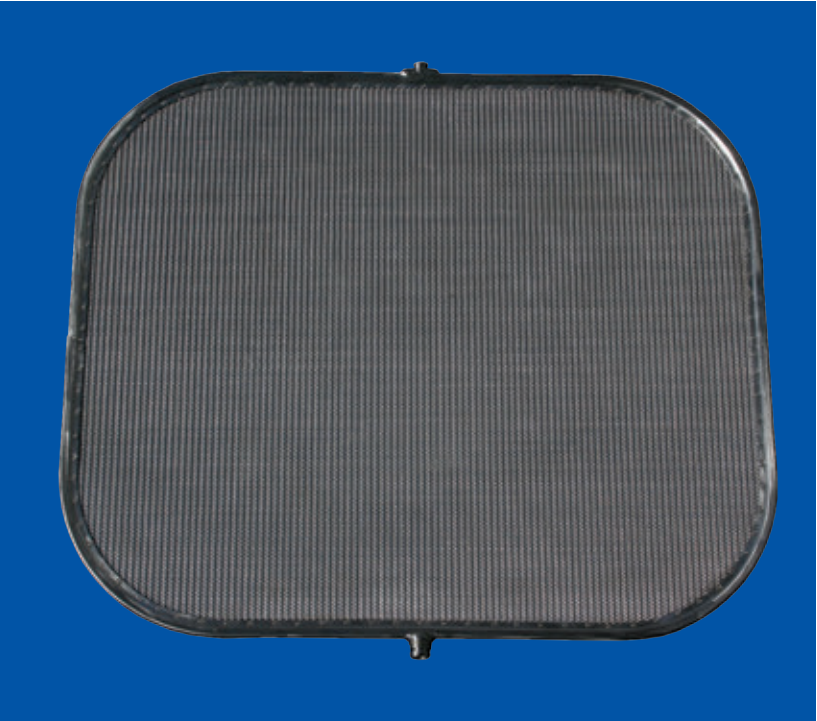

REBUILD



REPLACEMENT

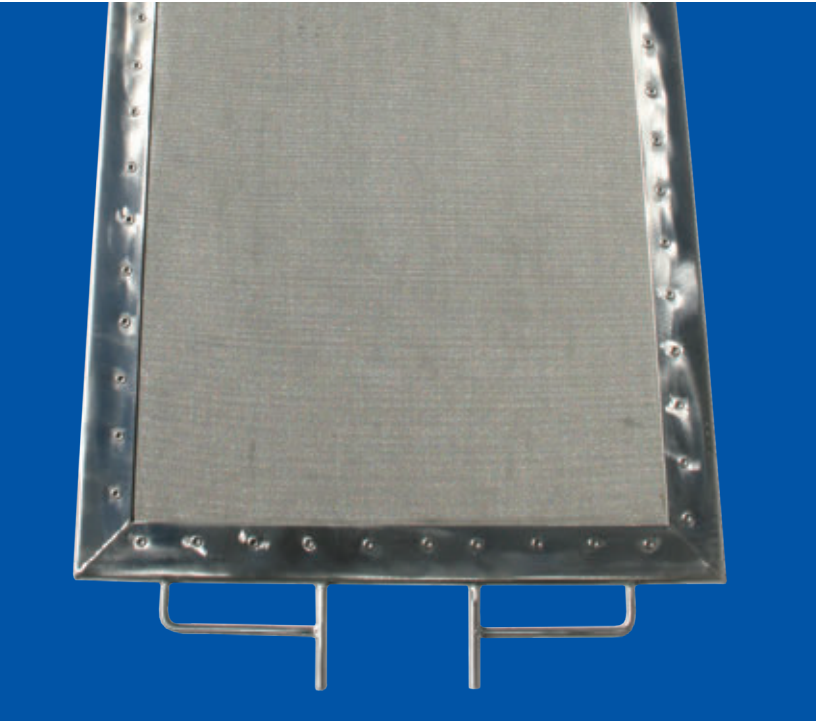

LEAF CLEANING SERVICES



LEAF CONSTRUCTION

“O” RING GASKET

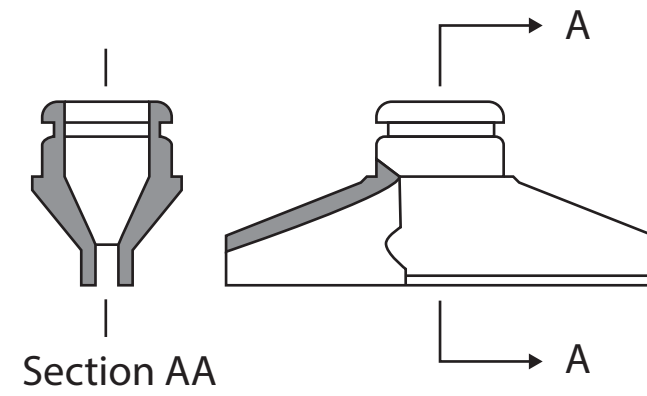

CENTER DRAIN-2 PIECE HUB (METAL)

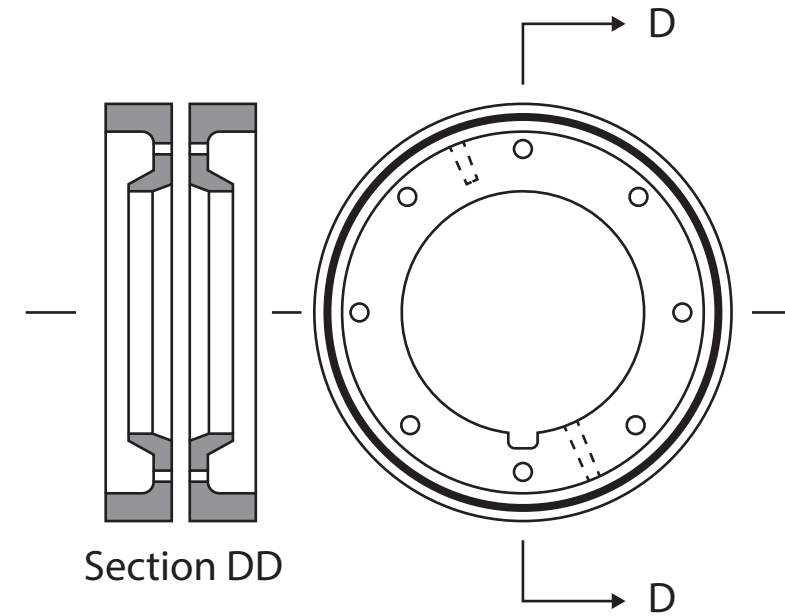

FLAT GASKET

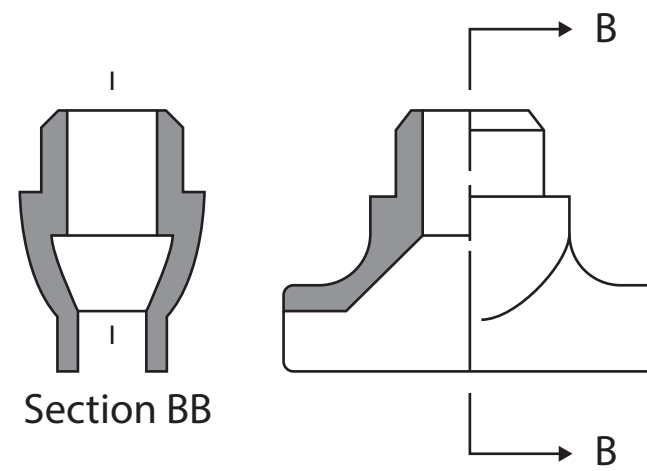

OUTLET WITH THREADED PIPE NIPPLE

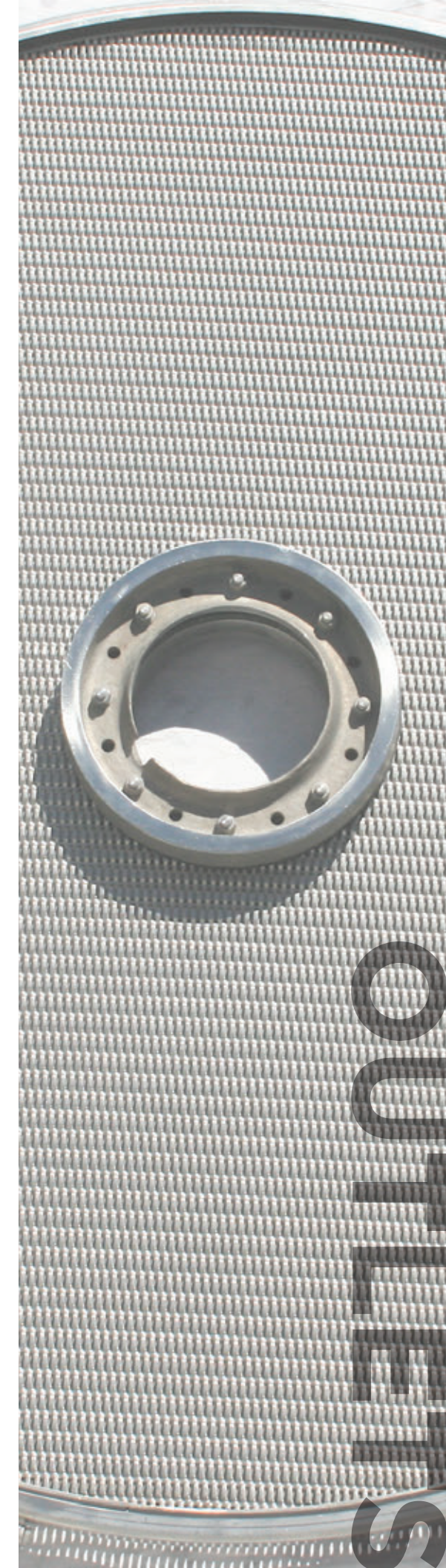
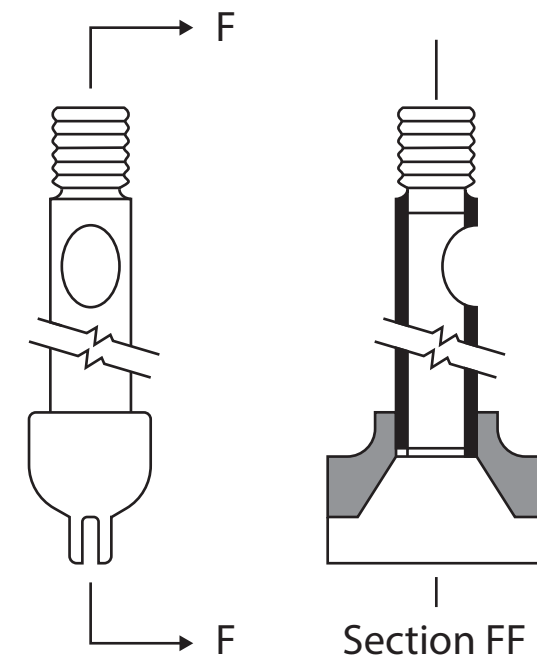

OUTLET

PORO-MAX
"STAGGERED" OUTLETS

A light-weight leaf support structure with exceptional strength and flow rate, results in a thicker, drier and more uniform cake distribution across the face of the filter leaf. Traditional wire mesh support typically has a thicker cake at the edges.

No more intermediate mesh support screen with broken wires to damage the filter cloth.

- Exceptional strength
- Increased flow rates
- More uniform, thicker and drier cake
- No broken wires on filter leafs
- Increased filter cloth life

BINDER: Back to Back U Channel

CHAMBER

Poro-Max with 2 Layers of Mesh Screen

CLOSURE

Welded

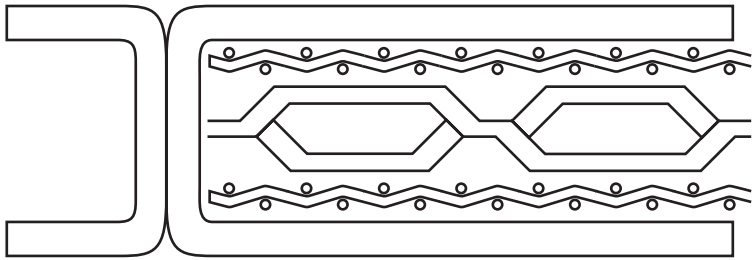

BINDER: U-Channel

CHAMBER

8 Mesh Over 1 Mesh

CLOSURE

Crimped

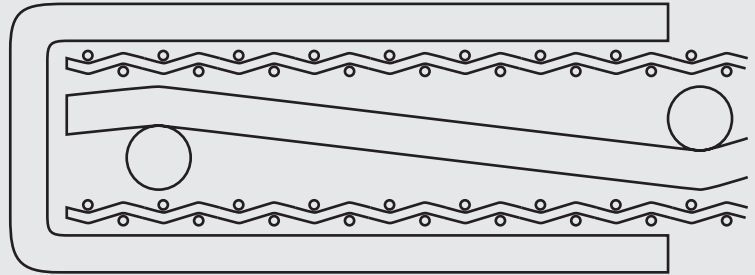

BINDER: Tee-Channel

CHAMBER

5 Layers of Mesh Screens

CLOSURE

Crimped

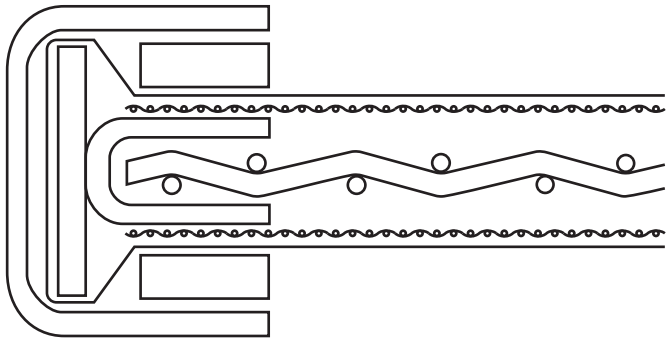

BINDER: Heavy Duty Keyhole Channel

CHAMBER

Poro-Max with 2 Layers of Wire Cloth

CLOSURE

Riveted

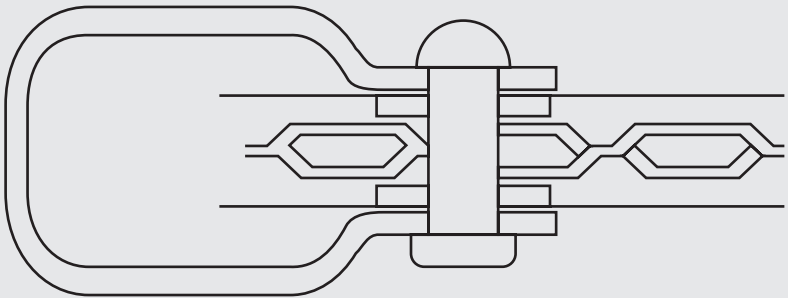

BINDER: Heavy Duty Tubular Frame

CHAMBER

7 ply of Mesh Screens

CLOSURE

Bolted

